

HW-ES-12

Lines 4

Lines 3

Lines 2

Lines 1

WIRING DIAGRAM

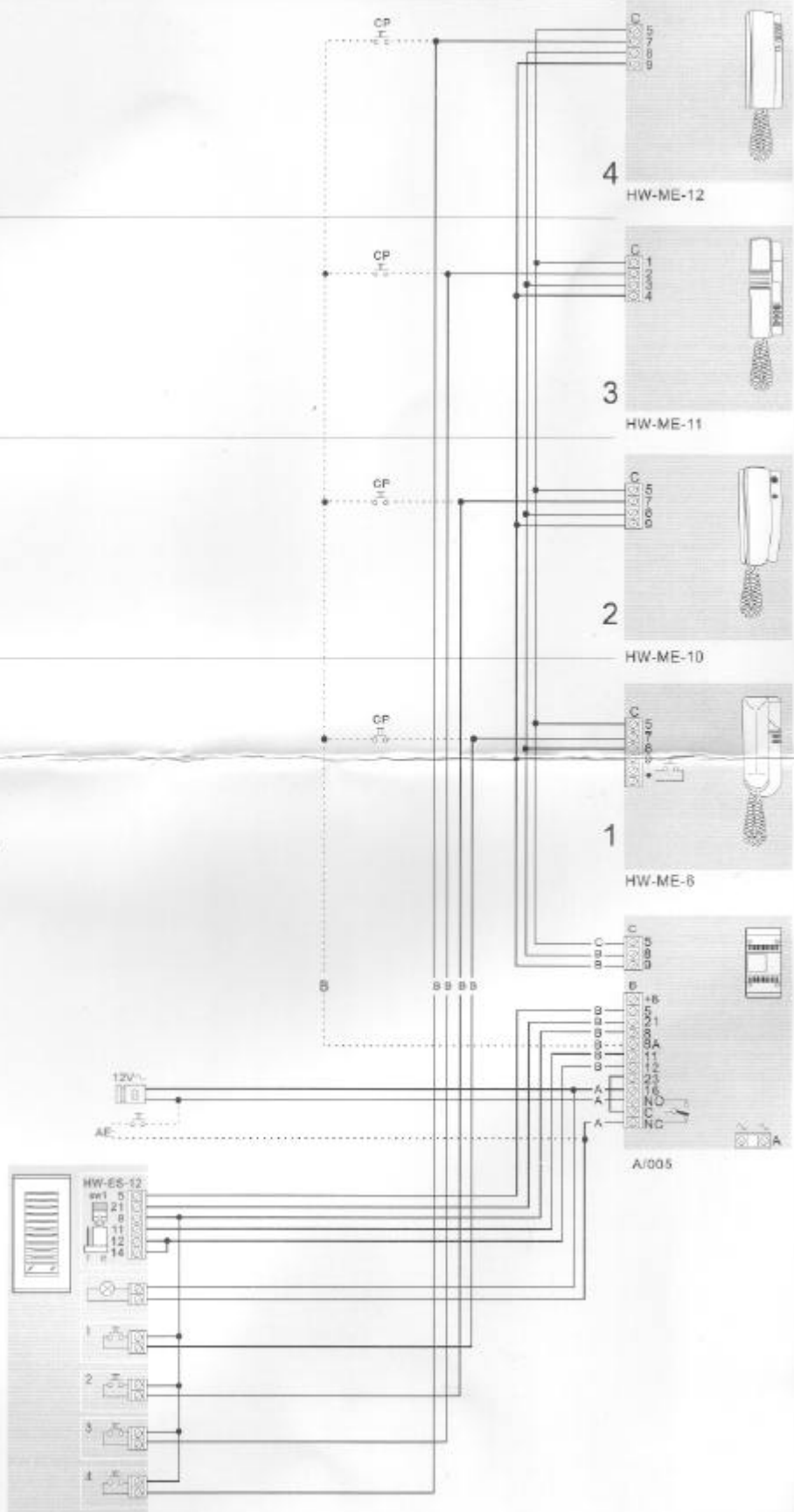
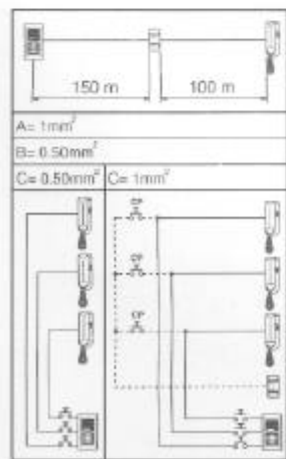

HW-ES-13A/HW-ES-13B

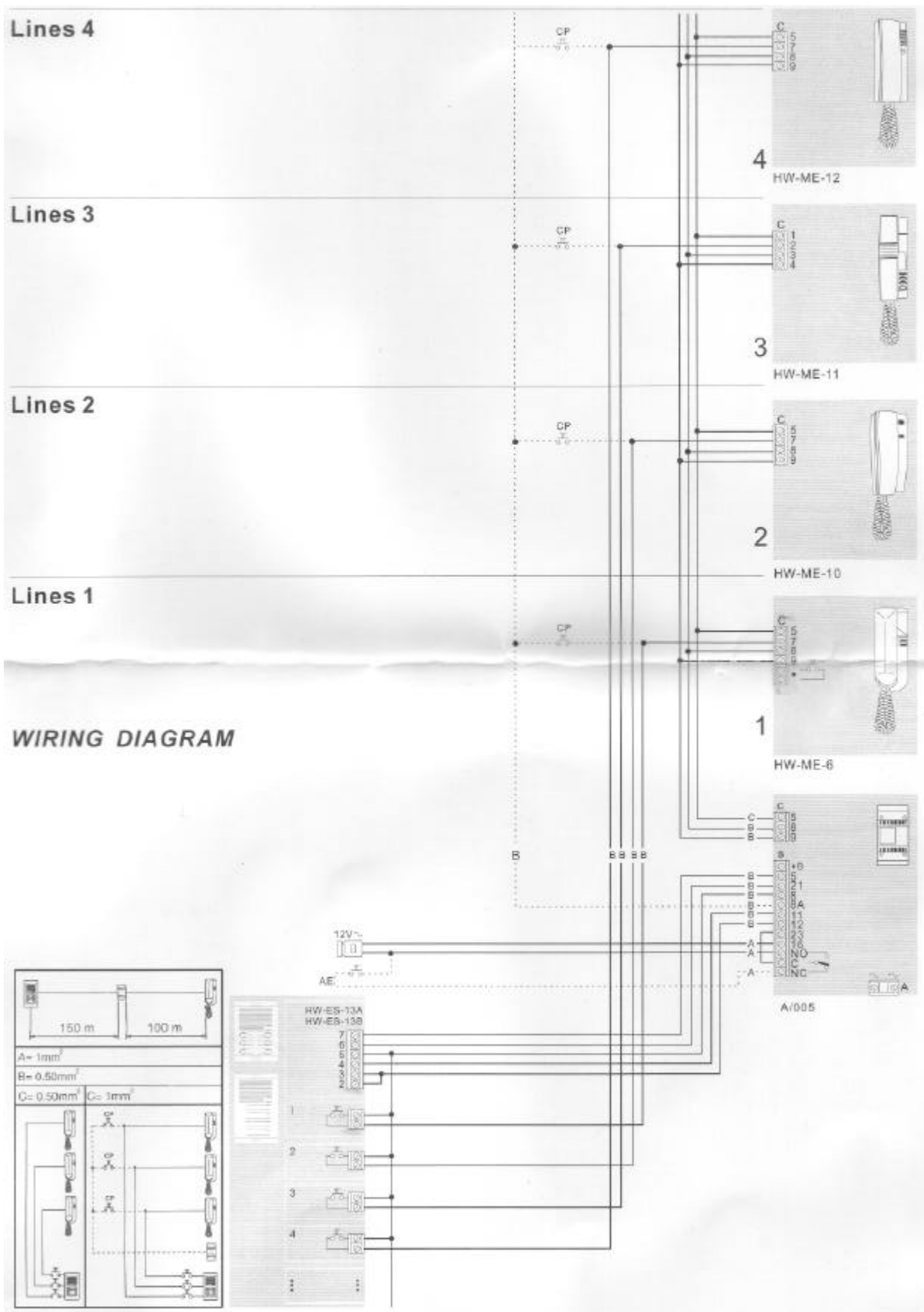

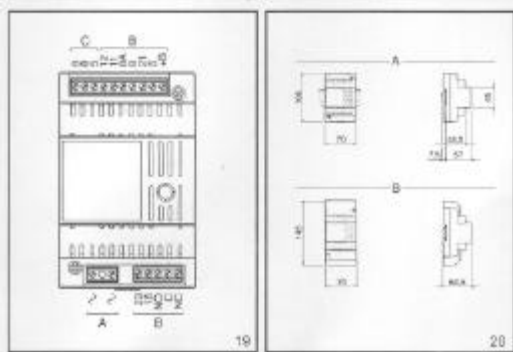
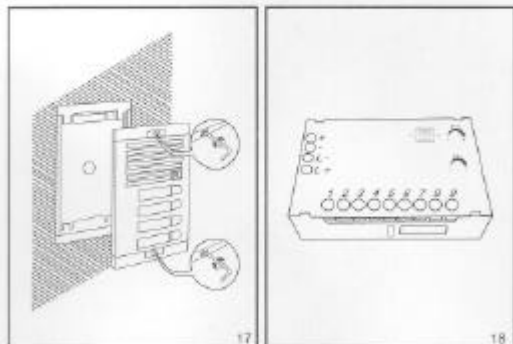
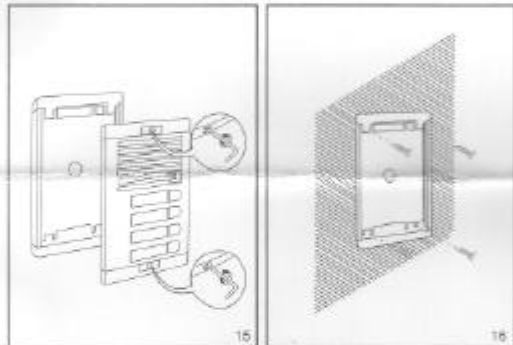
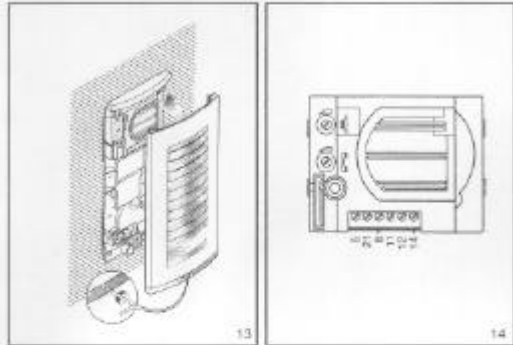
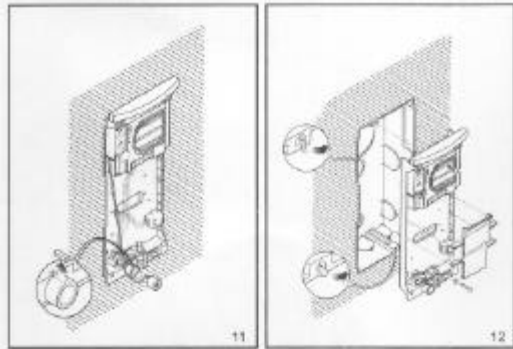

load and short-circuits.

? **Function of each terminal**, fig. 19

Terminal block A

mains

Terminal block B

+B input 12V DC 5

ground

21 output 11 V DC

8 call common output 1 8A

call common output 2 11

audio from entry panel 12

audio to entry panel

23] output 14V AC

16

NO normally open - relay

C common contacts

NC normally closed

Terminal block C

5 ground

8 audio to receiver

9 audio from receiver

Technical features

-Supply voltage: 230V±10% 50/60 Hz.
The transformer primary is electronically protected against overloading and short circuiting i.e. no fuses are used. The unit can be powered from a 12V DC power supply, e.g.. battery or uninterruptable power supply (terminals +B and 5).
NOTE. The unit has no battery protection.

? **Rated power. 15 VA.**

? **Output voltages:**

11 VDC, 150mA (300mA peak)

14 VAC, 650mA (1A in intermittent current).

?? Call generator: 2 types of two-tone call (up to 3 handset can be connected in parallel to the same call)

? **Working temperature range:** from -5°C to +35°C.

?? **Dimensions:** 4 DIN units module, low profile, figure 20

NOTE. Procedure to reset a triggered circuit:

- *Disconnect the mains from the power supplier*

- *Remove the cause of malfunction*

- *Let the power supplier to cool for at least 1 minute*

- *Reconnect the mains to the power supplier.*

INSTALLATION

HW-ME-6/HW-ME-10/HW-ME-12 handset

After having removed the cover (see figure 1/figure 3/figure 6), fix the base directly onto the wall (see figure 2/figure 4/figure 7).

On walls that are not completely flat do not tighten the screws fully. Make wiring connections and refit the handset cover.

HW-ME-11 handset

Fix a screw (@4x25mm) with screw anchor at an appropriate place on the

wall, leave the screw 2-3mm outstanding the wall. Then fix another screw same way at a point that is 97mm vertically downward. After performing wiring, fit the two hitching

holes on the back of the handset onto the two screws, and then slide downward slightly to firm the unit (fig.5).

Recessed entry panel

HW-ES-12

-The embedding box must be fitted flush with the wall at an appropriate height. -Fit the spacer into embedding boxes to avoid deformation (fig.9).

-Using the Allenkey s 2.5 supplied, unscrew the lock screw and remove the front plate from the chassis (fig. 10).

- Remove the two plugs protecting the threaded holes in the embedding box and secure the chassis using the two screws supplied (fig 12).

- Remove the cable-clamp plate and perform the wiring (fig.12).

-in those installations liable to be affected by the Larsen effect, the microphone can be fitted in a remote position, as indicated in figure 11.

- Refit the cable-clamp plate .

-The name card can be removed and filled in with the relevant information by removing the card clip followed by the actual card itself (fig.8).

NOTE. Personalized name cards can be used up to a maximum of 2 mm thick.

In order to fit the front plate, first insert the upper part in the top moulding and then tighten the lock screw (fig. 13)

HW-ES-13A/HW-ES-13B

-Using the Allenkey s 3 supplied to unscrew the fixing screw and remove the front plate from the base (fig.15)

-Cut a hollow on the wall at an appropriate height according to the installation dimension of the recessed chassis -Fit the chassis flush with the wall , fix it by four screws and screws anchors supplied (fig.16).

-Performing wiring for the entry unit according to the wiring diagram, to be sure the wires are all connected correctly.

-Refit the front plate onto the chassis by the two fixing screws (fig. 17). *NOTE: Take care that the button with room number is*

connected to the corresponding handset.

A/005 power supplier

The equipment can be installed without terminal covers into boxes provided with DIN rail .

Dimensions are shown in figure 20A. It can also be surface mounted, using the DIN rail supplied, but fitted with terminal covers.

Dimensions are shown in figure 20B.

Door Entry System Kit

GB INSTALLATION INSTRUCTIONS

WARNING FOR THE INSTALLER

These instructions should be attached to the handset.

WARNING FOR THE USER

Please do not open or tamper the device.

The device is operating with a very low voltage (24V AC) and cannot be connected to higher voltages.

In the case of breakdown or modification of the apparatus of the system (such as power supplier...) please contact a specialized maintenance service.

HW-ME-6 HANDSET

The wall mounted version features two push-buttons for the following commands:

- Door lock release button
- Auxiliary services

Door release and stairs light facilities can be activated even when the handset rests on the cradle.

Function of each terminal

- 5 ground
- 7 call
- 8 audio from entry panel
- 9 audio to entry panel

-] button for auxiliary services

HW-ME-10 HANDSET

The wall mounted version features two push-buttons for the following commands:

- Door lock release button
- Not defined

Function of each terminal

- 5 ground
- 7 call
- 8 audio from entry panel
- 9 audio to entry panel

HW-ME-11 HANDSET

The wall mounted version features three push-buttons for the following commands:

- Not defined
- ⊙ Not defined
- Door lock release button

Function of each terminal

- 1 ground
- 2 call
- 3 audio from entry panel
- 4 audio to entry panel

HW-ME-12 HANDSET

The wall mounted version features one push-button for the following command:

- Door lock release button

Function of each terminal

- 5 ground
- 7 call
- 8 audio from entry panel
- 9 audio to entry panel

Technical features

- Working temperature range: from -5°C to +35°C
- HW-ME-6 dimensions: 88×220×70mm
- HW-ME-10 dimensions: 97×215×63mm
- HW-ME-11 dimensions: 69×210×72mm
- HW-ME-12 dimensions: 79×216×49mm

ENTRY PANEL

HW-ES-12 audio module

The unit comes complete with

- loudspeaker;
- microphone which can be removed and fitted in a remote position where the installation features so require;
- two potentiometers for the following functions (fig. 14);

- entry panel volume control

- ⊙ receiver volume control

Function of each terminal

- 5 -] 12V DC supply voltage
- 21 +]
- 8 common call (for witness note)
- 11 audio to receiver
- 12 audio from receiver
- 14 enabling

NOTE. In installations which do not cater for the enabling control, terminal 14 can be connected to the earth (module always on) or terminal 12 (module on only when receiver is lifted).

HW-ES-13A /HW-ES-13B audio module

The unit comes complete with

- loudspeaker;
- microphone;
- lighting unit (automatically controlled)
- two potentiometers for the following functions: (fig. 18)

- entry panel volume control

- ⊙ receiver volume control

Function of each terminal:

- 2 enabling
- 3 audio from receiver
- 4 audio to receiver
- 5 common call (for witness note)
- 6 +] 12V, DC, supply voltage
- 7 -]

NOTE. In installations that do not cater for the enabling control, terminal 2 can be connected to the earth (module always on) or terminal 3 (module on only when receiver is lifted).

Technical features of entry panel

- Supply voltage of the audio module: 12V, DC.
- Current demand of the audio module: ma: 50mA (35mA quiescent).
- Current demand of the lighting module: 30mA 12V, DC.
- Max. switching capacity of the microcontact: 24V, 1A.
- Working temperature range: from -15°C to +50°C.

A/005 POWER SUPPLIER

Comprising a 15 VA transformer, electronically protected against over-

